

Part number

C7AP 10.21



Brief description:

surface mounting housings with 2 levers, size "57.27", Pg21, metal version, IP66/ IP67

Product description	
Version	C7 - CV and M7 - MV enclosures, V-Type lever version
Series	Surface mounting housings with two levers
Product type	with 2 stainless steel levers
Style	high construction
Family	C7 - CV and M7 - MV enclosures, V-Type lever version
Size	size "57.27"
Technical data	
Operating temperature range (min, max)	-40 °C...+125 °C
Material	metal
IP degree of protection	IP66/ IP67 (EN 60529) and IP69K (DIN 40050 - 9) degree of protection.
Cable entry	Pg21
Further technical details	
Weight	380,00 g

Approvals / Standards	
Quality mark	UL (type:4/4X/12), CE, EAC
Conformity	CQC, CE
General ordering information	
EAN13 code	8015747060271
Tariff number	85369095
Packaging Information	
Packaging length	475,00 mm
Packaging height	200,00 mm
Packaging width	150,00 mm
Packaging weight	7,60 kg
Packaging volume	14,25 dm ³
Packaging description	Carton box
Packaging quantity	10 Pcs
Packaging EAN code	8015747248822
Sub-packaging weight	3,80 kg
Sub-packaging description	Plastic packaging
Sub-packaging quantity	5 Pcs
Sub-packaging EAN barcode	8015747115230

Part number

C7AP 10.21



Catalogue drawings

C7P - C7AP M7P - M7AP

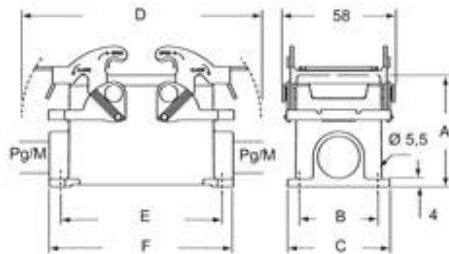

	A	B	C	D	E	F
C7P/M7P 10	57	40	52	122	82	93,5
C7P/M7P 16	63	45	57	142,5	105	117
C7P/M7P 24	63	45	57	169	132	144
C7AP/M7AP 10	73	45	57	122	82	93,5
C7AP/M7AP 16	77	45	57	142,5	105	117
C7AP/M7AP 24	80	45	57	169	132	144

Notes

The new lever, due to the vertical closing movement, offers an IP66/IP67 protection rating (according to EN 60529) when fitted with a complete and coupled connector and used with ILME standard hoods in die cast aluminum with pegs (without adaptor).