

Data Sheet

RP025xxIBLC

Illustration

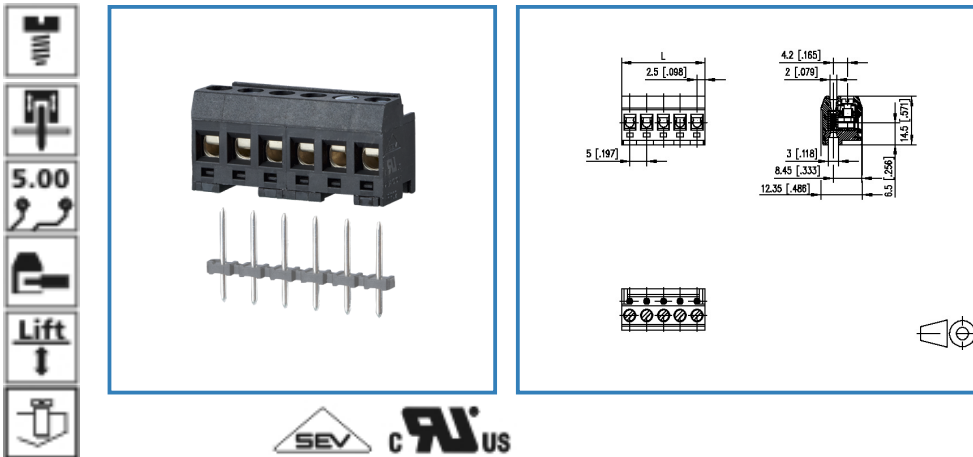

see enlarged drawing at the end of the document

Product specification

- screw type terminal block, Stecker
- centerline 5.00 mm, direction of connection 90°
- lift system, fittable without loss of poles
- color black
- wire entry perpendicular to plug direction, lamella

© 2017 METZ CONNECT - Technische Änderungen vorbehalten! Subject to modifications! Sous réserve de modifications techniques!

Data Sheet

RP025xxIBLC

Technical Data



General Data

| | | | |
|---------------------------|-----------|---------|---------|
| Tightening torque SEV | 0.5 Nm | | |
| Tightening torque UL | 4.5 lb-in | | |
| min. number of poles | 2 | | |
| max. number of poles | 24 | | |
| Insulating material class | CTI 600 | | |
| clearance/creepage dist. | 3.2 mm | | |
| protection category | IP 20 | | |
| Overvoltage category | III | III | II |
| Pollution degree | 3 | 2 | 2 |
| Rated voltage | 250.0 V | 630.0 V | 630.0 V |
| Rated test voltage | 4.0 kV | 4.0 kV | 4.0 kV |

Connection data

| | | | |
|----------------------------|--|--|--|
| Rated wiring solid wire | 0.13 - 2.5 mm ² / AWG 26 - 12 | | |
| Rated wiring stranded wire | 0.13 - 2.5 mm ² / AWG 26 - 12 | | |

Approvals

| | | | |
|--|--|--|--|
|  V / A / AWG | 300 / 15 / 26 - 12 | | |
|  | 10 A / 250 V / 2.5 kV / 3 / / 0.12 - 2.5 mm ² | | |

Material

| | |
|-----------------------------|-------------------------------|
| insulating material | PA66 |
| flammability class | V0 |
| contact material | CuBe |
| Glow-Wire Flammability GWFI | 960 °C acc. to IEC 60695-2-12 |
| Glow-Wire Flammability GWIT | 775 °C acc. to IEC 60695-2-13 |
| contact surface | Ni + Ag |
| terminal body material | CuZn |
| terminal body surface | Cu + Ni |
| screw surface | Zn Cr(VI)-frei/free |
| wire protector material | CuNiZn |



Data Sheet

RP025xxIBLC

| | |
|--------------|----|
| screw thread | M3 |
|--------------|----|

Climatic properties

| | |
|-------------------------|--------|
| upper limit temperature | 105 °C |
| lower limit temperature | -40 °C |

General

| | |
|-----------|--------------|
| Tolerance | ISO 2768 -mH |
|-----------|--------------|



Data Sheet RP025xxIBLC

Page 4/5

P/N

311371xx

xx=number of poles

2018/02/02

Matching Part

| P/N | Product name |
|--------|---------------------|
| 310271 | PR015xxVBVC Typ 027 |

Accessories

| P/N | Product name |
|--------------------------|--------------|
| 716846 | 716846 |
| 720161-01-2 (on request) | 720161 |
| 720161-02-2 (on request) | 720161 |
| 750313 | 750313 |
| 750314 | 750314 |



Data Sheet

RP025xxIBLC

Illustration

Drawing

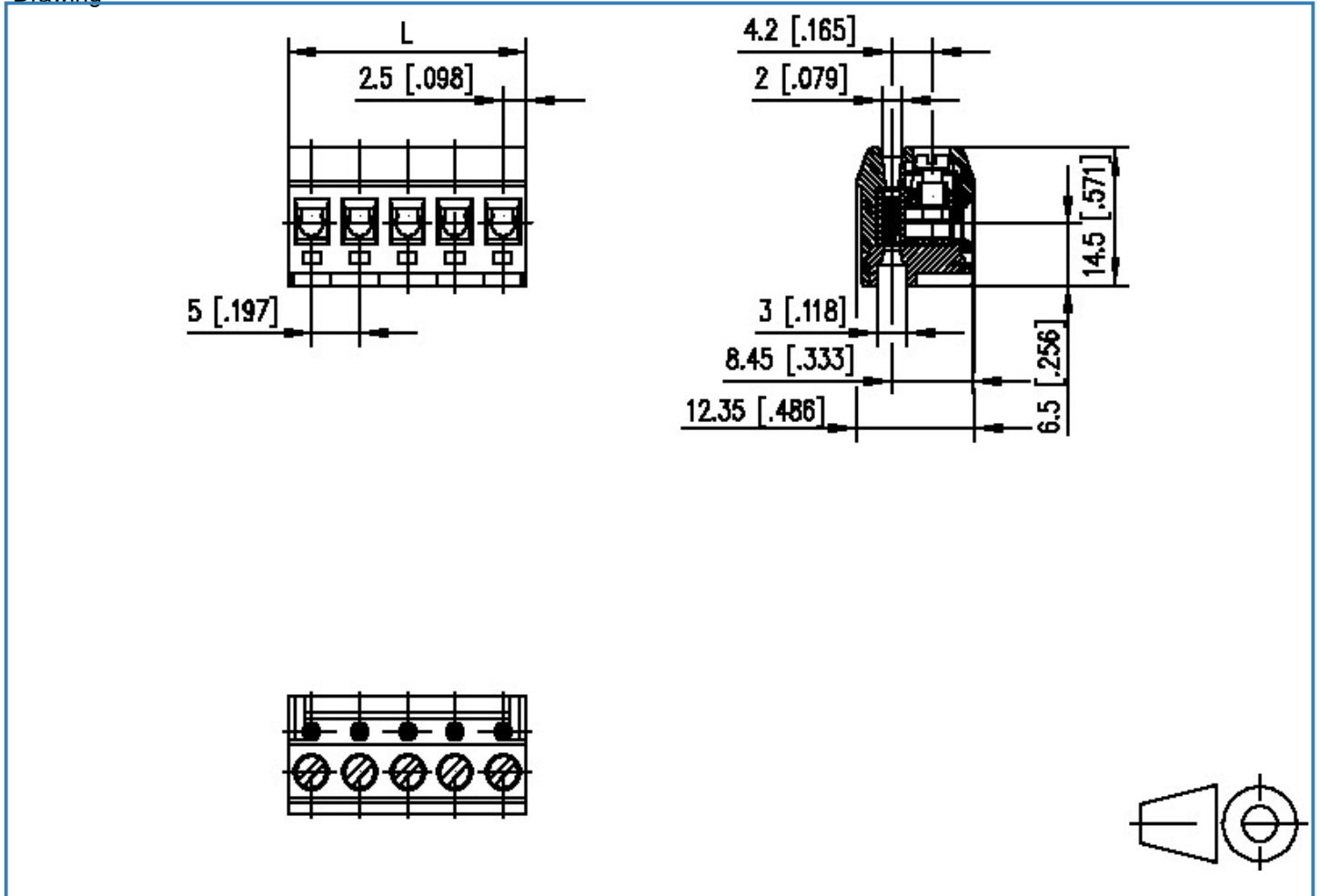

$$L = (\text{pole size} - 1) \times \text{centerline} + 5 [0.197]$$

