

Data Sheet

RP023xxHBWC

Illustration

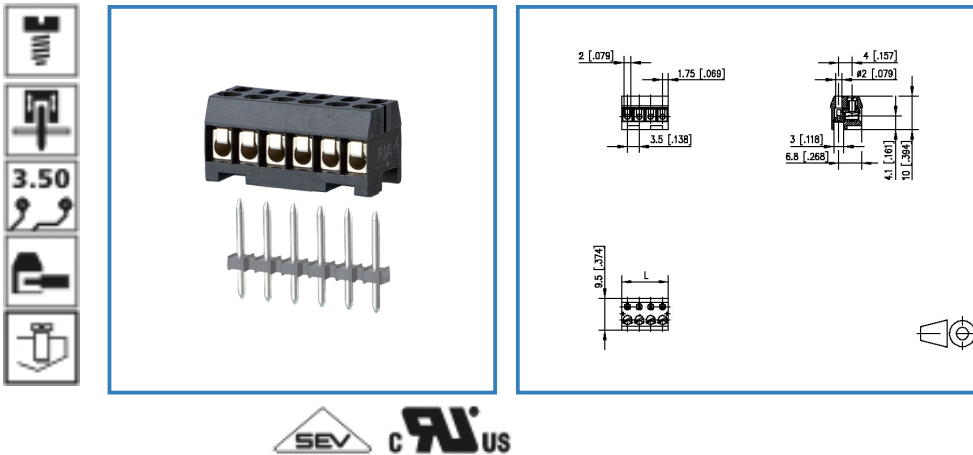

see enlarged drawing at the end of the document

Product specification

- screw type terminal block, Stecker
- centerline 3.50 mm, direction of connection 90°
- wire protector, fittable without loss of poles
- color black
- Wire entry perpendicular to plug direction

Data Sheet

RP023xxHBWC

Technical Data



General Data

Tightening torque SEV	0.15 Nm		
Tightening torque UL	3 lb-in		
min. number of poles	2		
max. number of poles	24		
Insulating material class	CTI 600		
clearance/creepage dist.	2 mm		
protection category	IP 00		
Overvoltage category	III	III	II
Pollution degree	3	2	2
Rated voltage	32.0 V	250.0 V	250.0 V
Rated test voltage	1.5 kV	1.5 kV	1.5 kV

Connection data

Rated wiring solid wire	0.08 - 0.75 mm ² / AWG 28 - 18		
Rated wiring stranded wire	0.08 - 0.75 mm ² / AWG 28 - 18		

Approvals

 V / A / AWG	125 / 8 / 28 - 16		
	6 A / 200 V / 2.5 kV / 3 / / 0.08 - 1 mm ²		

Material

insulating material	PA66
flammability class	V0
contact material	CuNiZn
Glow-Wire Flammability GWFI	960 °C acc. to IEC 60695-2-12
Glow-Wire Flammability GWIT	775 °C acc. to IEC 60695-2-13
terminal body material	CuZn
terminal body surface	Ni
screw surface	Zn Cr(VI)-frei/free
wire protector material	CuNiZn
screw thread	M2



Data Sheet

RP023xxHBWC

Page 3/5

P/N

311661xx

xx=number of poles

2018/02/02

Climatic properties

upper limit temperature	105 °C
-------------------------	--------

lower limit temperature	-40 °C
-------------------------	--------

General

Tolerance	ISO 2768 -mH
-----------	--------------



Data Sheet

RP023xxHBWC

Page 4/5

P/N

311661xx

xx=number of poles

2018/02/02

Matching Part

P/N	Product name
312241	PR033xxVBHC Typ 224
312251 (on request)	PT153xxHBEC Typ 225
312261	PT153xxVBEC Typ 226
313331 (on request)	PT023xxHBHC
314241	PM013xxVBHC Typ 424

Accessories

P/N	Product name
720158-01-0 (on request)	F_Befest_165_brg_kurz 1mm
720158-01-2 (on request)	720158
720158-02-2	720158
720159-01-0 (on request)	F_Kodier_Typ165_brg_kurz
720159-01-2	720159
720159-02-0 (on request)	F_Kodier_Typ165_brg_lang
720159-02-2	720159



Data Sheet

RP023xxHBWC

Illustration

Drawing

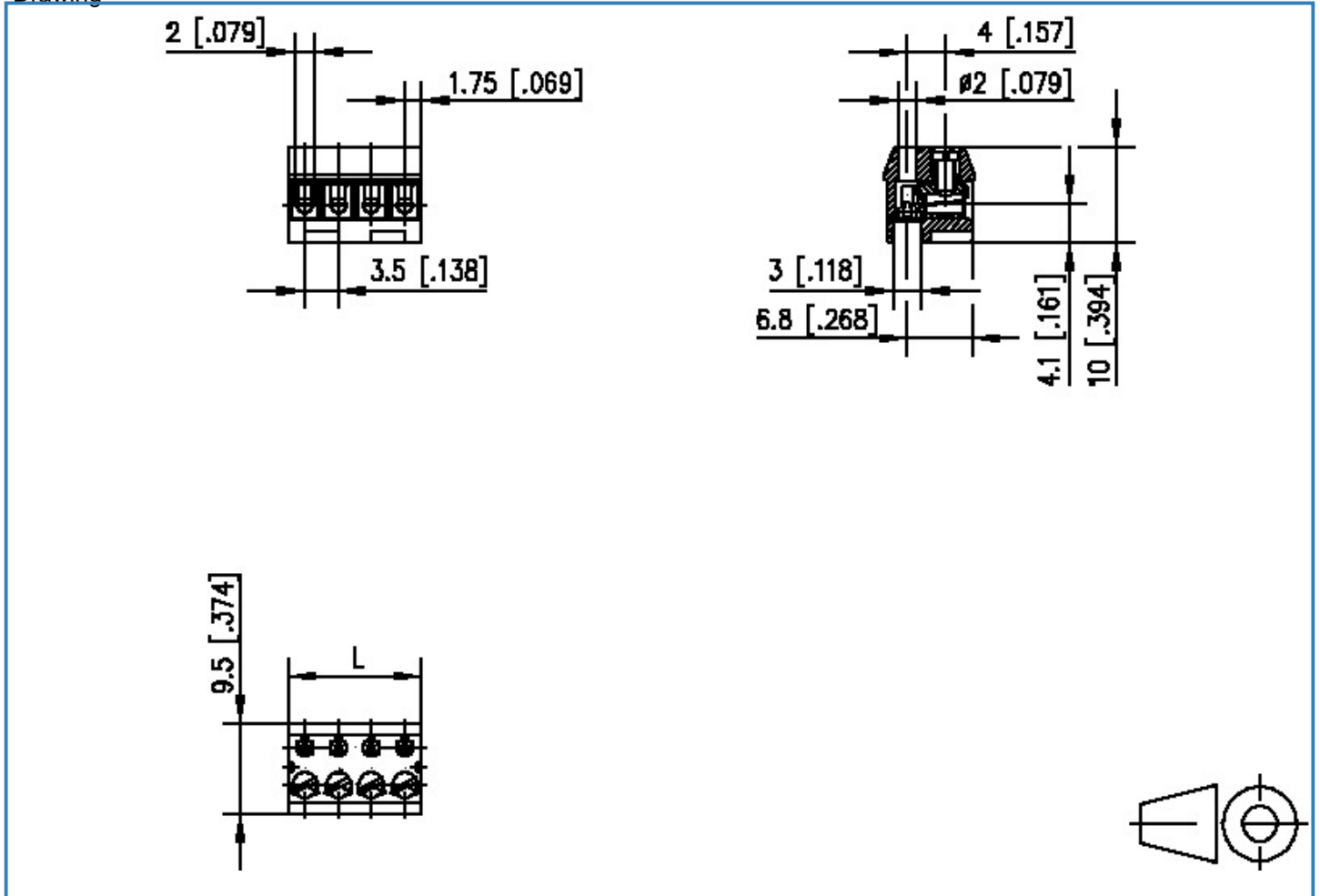

$$L = (\text{pole size} - 1) \times \text{centerline} + 3.5 [0.138]$$

