

Data Sheet

360291

Page 1/4

P/N

360291

2018/02/01

Illustration

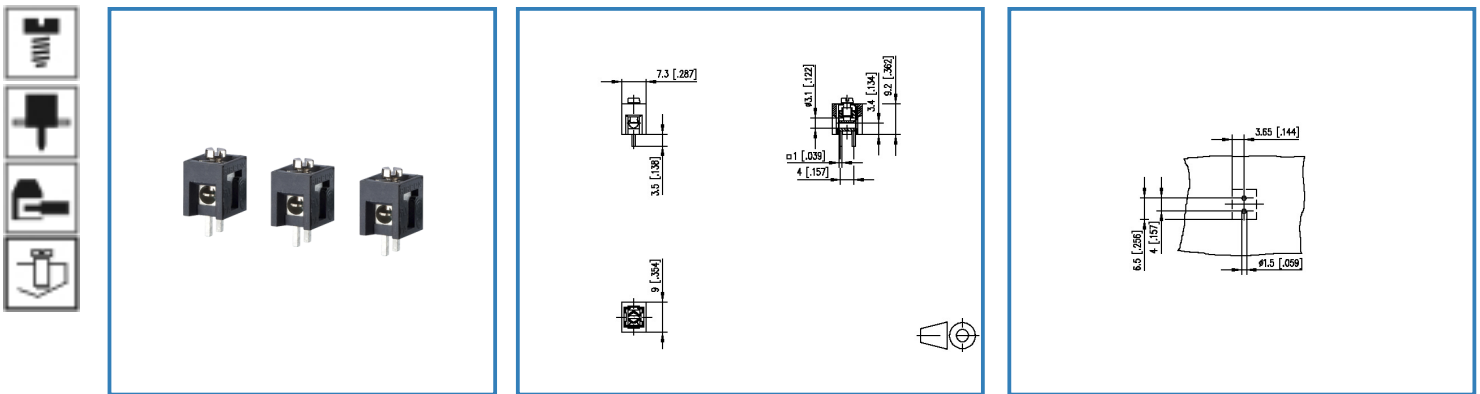

RIA US

see enlarged drawing at the end of the document

Product specification

- screw type terminal block, solderable, double solder pins
- direction of connection 90°
- wire protector
- color black
- with molded housing, screw brought down by hand (transport safety)

© 2017 METZ CONNECT - Technische Änderungen vorbehalten! Subject to modifications! Sous réserve de modifications techniques!



Data Sheet

360291

Technical Data

General Data

| | |
|---------------------------|---------|
| Tightening torque SEV | 0.5 Nm |
| Tightening torque UL | 7 lb-in |
| Solder pin length | 3.5 mm |
| min. number of poles | 1 |
| max. number of poles | 1 |
| Insulating material class | CTI 600 |

Connection data

| | |
|----------------------------|--|
| Rated wiring solid wire | 0.33 - 2 mm ² / AWG 22 - 14 |
| Rated wiring stranded wire | 0.33 - 1.5 mm ² / AWG 22 - 14 |

Approvals

| | |
|--|-------------------|
|  V / A / AWG | 50 / 15 / 22 - 14 |
|--|-------------------|

Material

| | |
|-------------------------|---------------------|
| terminal body material | CuZn |
| terminal body surface | Ni + Sn |
| screw surface | Zn Cr(VI)-frei/free |
| wire protector material | CuNi18 |
| screw thread | M3 |

Climatic properties

| | |
|-------------------------|--------|
| upper limit temperature | 105 °C |
| lower limit temperature | -40 °C |

General

| | |
|---------------|-------------------------------------|
| solderability | Acc. to JEDEC JESD22-B102E 245°C/5s |
| Tolerance | ISO 2768 -mH |



Data Sheet

360291

Illustration

Drawing

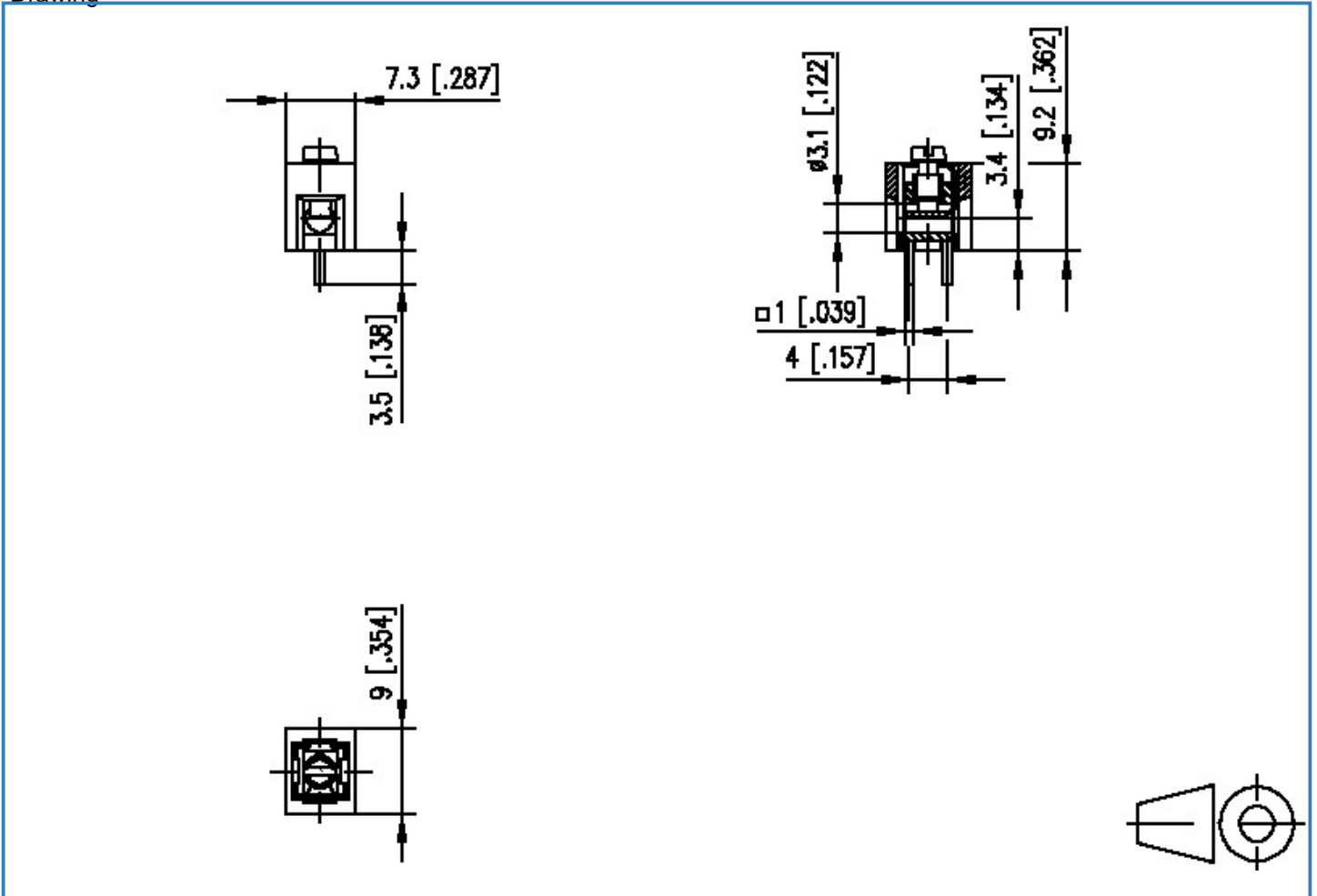

Data Sheet

360291

Page 4/4

P/N

360291

2018/02/01

PCB Layout

