

# Data Sheet

## SP025xxHDNC

### Illustration

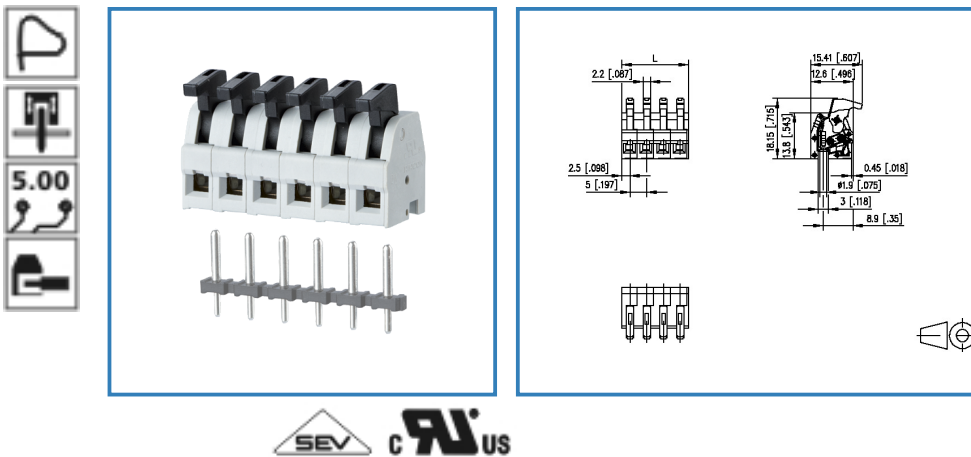

see enlarged drawing at the end of the document

### Product specification

- spring clamp terminal block, Stecker
- centerline 5.00 mm, direction of connection 90°
- fittable without loss of poles
- color gray
- eccentric lever, wire entry perpendicular to plug direction

© 2017 METZ CONNECT - Technische Änderungen vorbehalten! Subject to modifications! Sous réserve de modifications techniques!



# Data Sheet

## SP025xxHDNC

Page 2/5

P/N

ASP025xx

xx=number of poles

2018/02/02

### Technical Data



#### General Data

min. number of poles	2		
max. number of poles	24		
Insulating material class	CTI 400		
clearance/creepage dist.	3.7 mm		
protection category	IP 20		
Overvoltage category	III	III	II
Pollution degree	3	2	2
Rated voltage	32.0 V	200.0 V	200.0 V
Rated test voltage	1.5 kV	1.5 kV	1.5 kV

#### Connection data

Rated wiring solid wire	0.08 - 1.5 mm <sup>2</sup> / AWG 28 - 16
Rated wiring stranded wire	0.08 - 0.75 mm <sup>2</sup> / AWG 28 - 18

#### Approvals

 V / A / AWG	300 / 8 / 28 - 16
	10 A / 250 V / 4 kV / 3 / / 0.08 - 1.5 mm <sup>2</sup>

#### Material

insulating material	PA46
flammability class	V0
spring material	Spring steel
contact material	CuSn
Glow-Wire Flammability GWFI	-
Glow-Wire Flammability GWIT	-
contact surface	Sn

#### Climatic properties

upper limit temperature	105 °C
lower limit temperature	-40 °C

#### General

Tolerance	ISO 2768 -mH
-----------	--------------



# Data Sheet

## SP025xxHDNC



# Data Sheet

## SP025xxHDNC

Page 4/5

P/N

ASP025xx

xx=number of poles

2018/02/02

### Matching Part

P/N	Product name
310171	PR015xxVBHC Typ 017
310391	PT055xxHBHC Typ 039
310411	PT065xxVBEN Typ 041
314171	PM035xxVBHC Typ 417

### Accessories

P/N	Product name
720036-01-4	720036
720036-02-2	720036



# Data Sheet

## SP025xxHDNC

### Illustration

Drawing

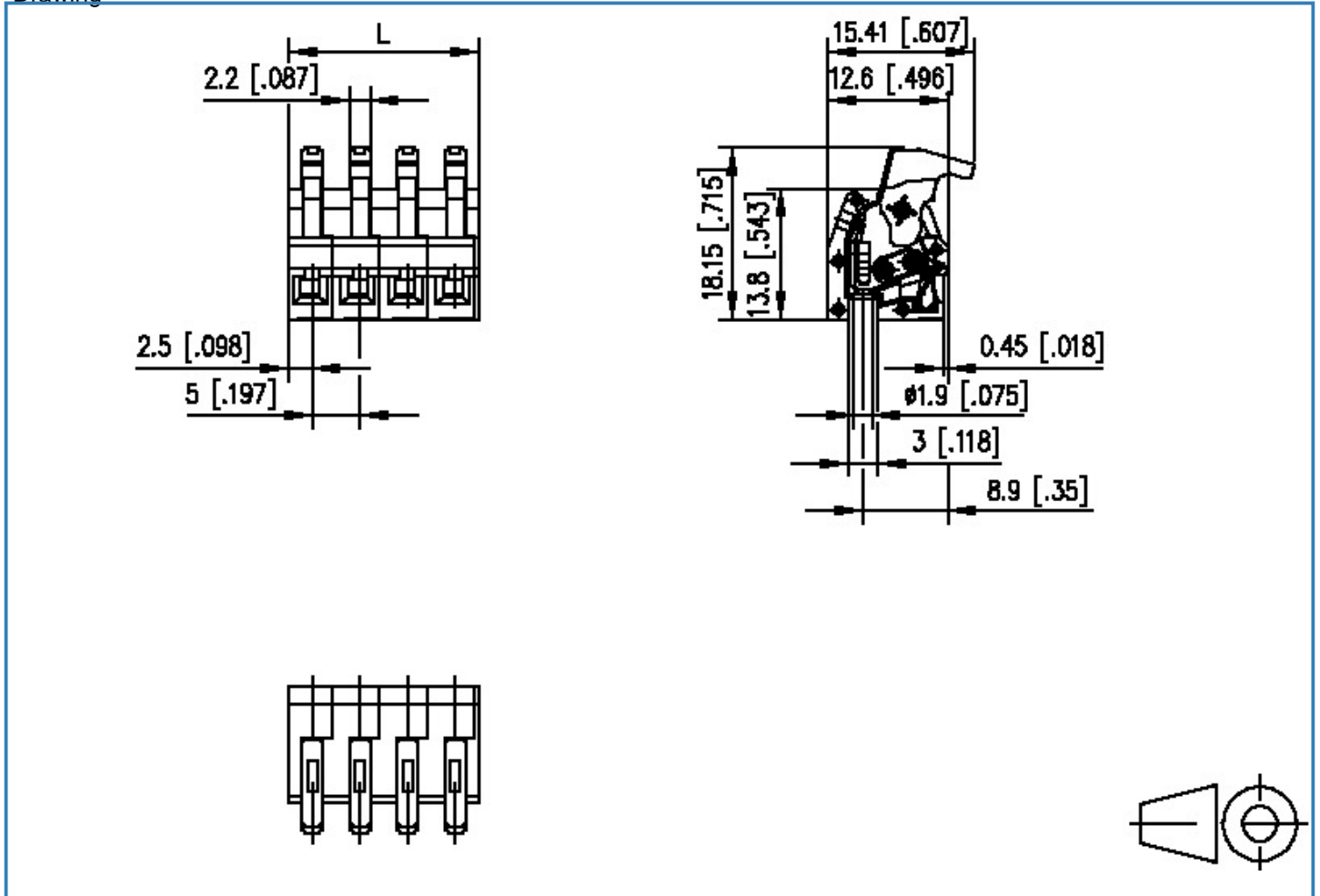

$$L = (\text{pole size} - 1) \times \text{centerline} + 5 [0.197]$$