

Part number

# CRF



## Brief description:

dual coding and guide pins, for 16 codes, female pin, in stainless steel

Product description		General ordering information	
Series	multipole inserts accessories	EAN13 code	8015747038478
Product type	dual coding and guide pins, for 16 codes	Tariff number	85369095
Style	female pin, in stainless steel	Packaging Information	
Family	accessories for multipole connectors	Packaging length	112,00 mm
Further technical details		Packaging height	95,00 mm
Weight	3,07 g	Packaging width	117,00 mm
		Packaging weight	1,22 kg
		Packaging volume	1,24 dm <sup>3</sup>
		Packaging description	Carton box
		Packaging quantity	400 Pcs
		Packaging EAN code	8015747206747
		Sub-packaging length	50,00 mm
		Sub-packaging height	44,00 mm
		Sub-packaging width	50,00 mm
		Sub-packaging weight	0,15 kg
		Sub-packaging volume	0,11 dm <sup>3</sup>
		Sub-packaging description	Plastic box
		Sub-packaging quantity	50 Pcs
		Sub-packaging EAN barcode	8015747038485

Part number

# CRF



## Catalogue drawings

**CRM / CRM D**

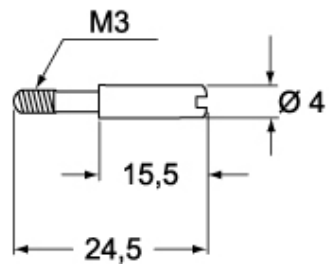

**CRF /CRF D**

